

ENGINE FUEL

CARBURETOR AIR CLEANER AND SILENCER

An oil wetted polyurethane filter is standard on all models with a heavy duty air cleaner available on all engines except the 400 Ram-Air.

Service instructions for air cleaners are found in the General Lubrication Section of the 1967 Pontiac Service Manual.

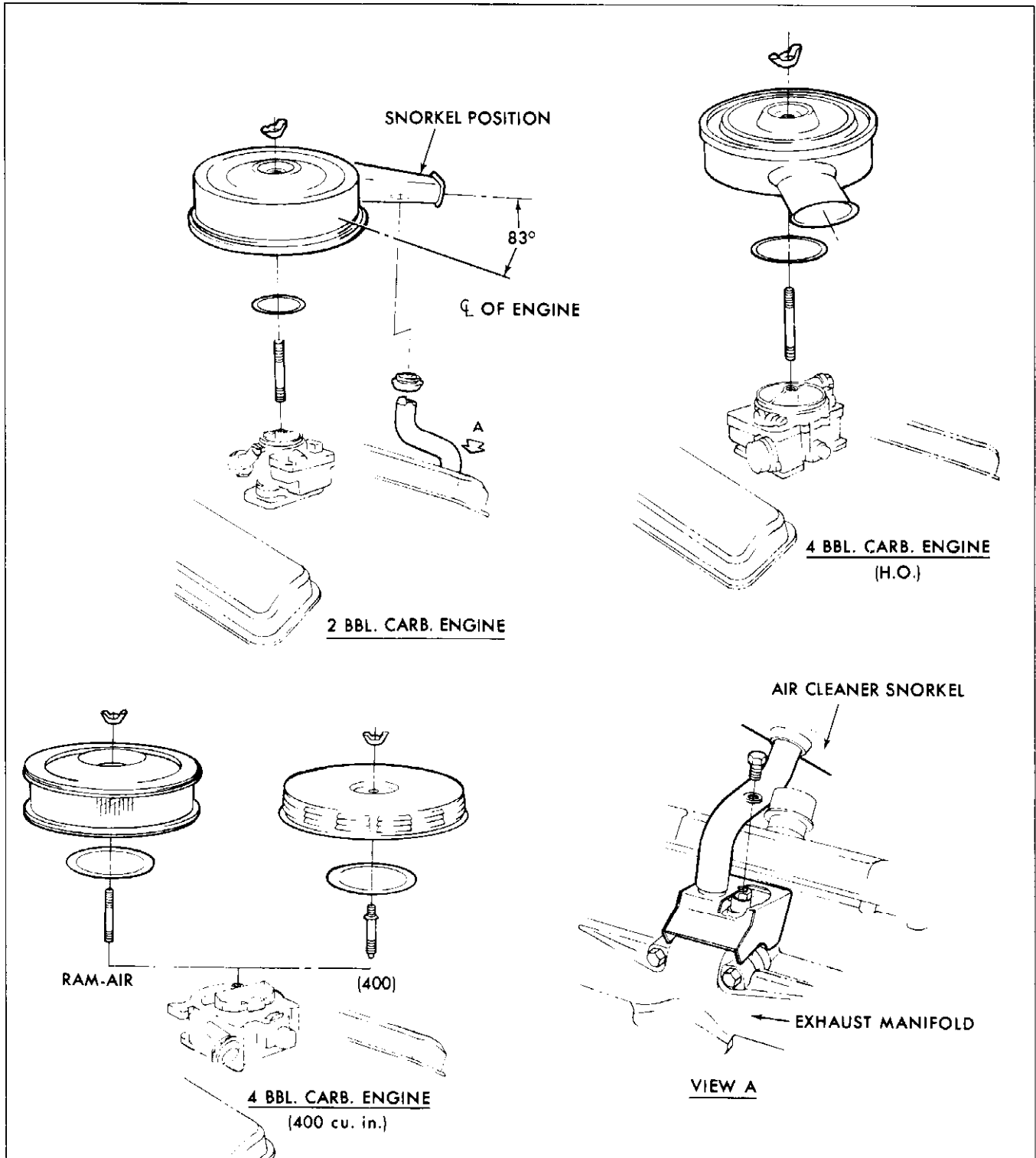

Fig. 6B-1 Air Cleaner and Heater Stove Assembly

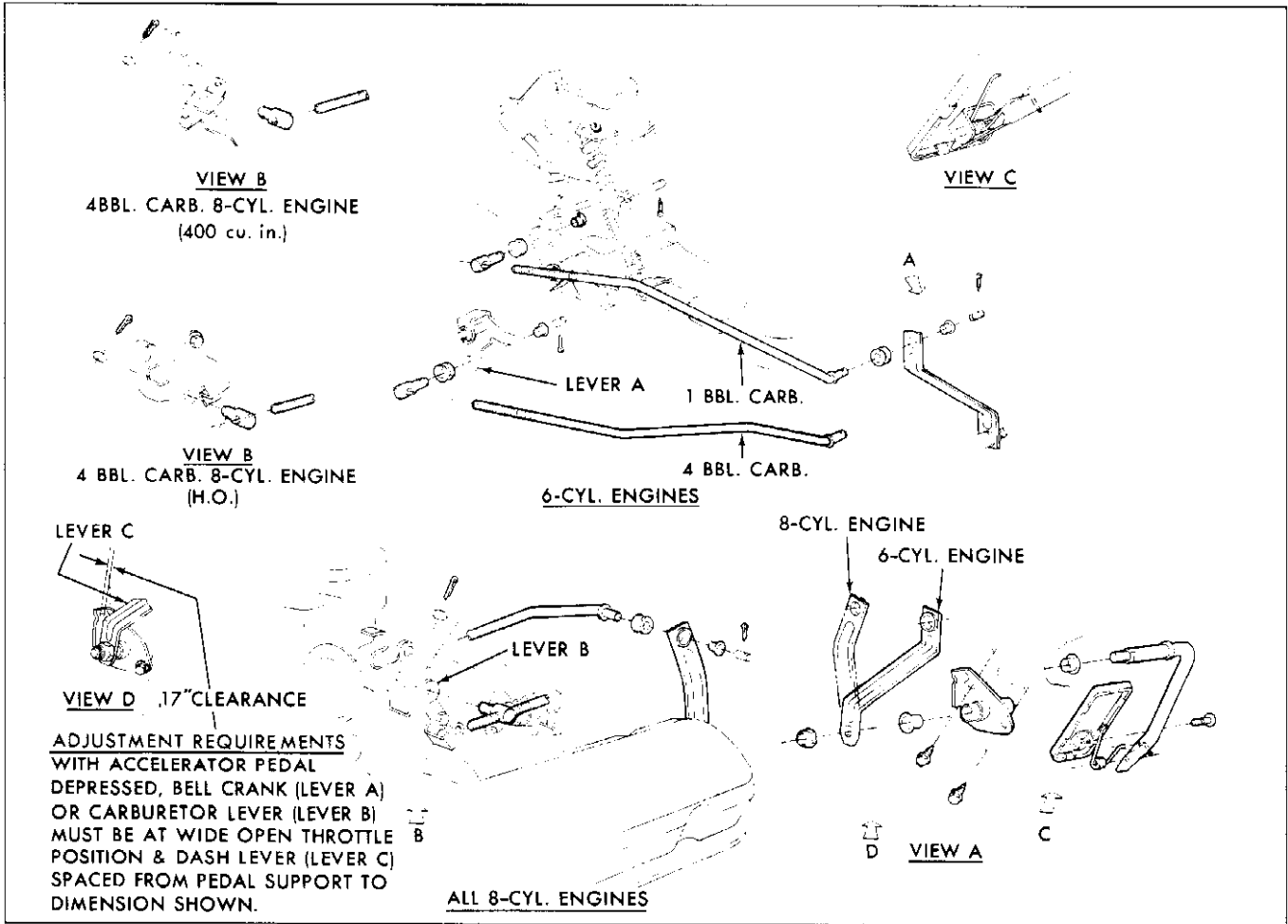

Fig. 6B-2 Accelerator Linkage - 6-Cyl. and 8-Cyl.

CARBURETOR AIR PRE-HEATER

A carburetor air pre-heater is standard on 326 cu.in. engines (2 bbl.) with automatic transmission. Hot air is drawn from the stove mounted on the exhaust manifold and passed to intake of the air cleaner (Fig. 6B-1).

THROTTLE RETURN CHECK

A throttle return check is standard on V-8 engines with automatic transmission except the 326 2 bbl. engines and the 400 Ram-Air engines. On six cylinder A/C cars an idle speed-up device is used.

	ENGINE HOT IDLE SPEEDS WITHOUT A.I.R. SYSTEM				WITH A.I.R. SYSTEM		
	6-CYL	326	400	400 (RAM-AIR)	6-CYL	326 & 400	400 (RAM-AIR)
AT	500	500	600	650	600	600	650
AT-A/C	500	600	600	650	600	600	650
MT	600	600	700	1200	700	700	1200
MT-A/C	600	700	700	1200	700	700	1200

All A.T. Speeds Set in Drive and A/C off (if Equipped)

Fig. 6B-3 Engine Hot Idle Speeds

Carburetor Model	Float Level	Pump	Choke Rod	Idle Vent	Vacuum Break	Air Valve Lockout	Dashpot	Unloader	Choke Setting	Fast Idle
Rochester 4MV										
7027273	3/16"	9/32"	.090	3/8"	.225	.020	.030	.325	Center	2500
7037272	↓	With Pump Rod in Inner Hole	.040	↓	.160	↓	↓	↓	Notch	2500
7037276	↓		.040	↓	.160	↓	↓	↓		2800

Fig. 6B-4 Quadrajets Service Specifications

ACCELERATOR LINKAGE

The throttle control system is of the rod and lever type. The throttle control rod which is threaded at the carburetor end is attached to the carburetor linkage by means of a threaded trunnion (Fig. 6B-2).

Check linkage adjustment with carburetor set at hot idle position and also check for full throttle opening with accelerator fully depressed. Adjust as necessary by removing cotter pin and turning trunnion to obtain the correct opening and closing positions.

NOTE: No binding should be felt in linkage.

VAPOR DIVERTER

The vapor diverter on the A/C equipped six cylinder 4 bbl. engine is incorporated in the fuel pump. Vapor diverters are standard equipment on all Firebird 400 cubic inch engines and on all other V-8 engines with air conditioning.

FUEL PUMP

Fuel pump specifications are the same as those used on 1967 Tempest models.

Fuel lines are of steel and attached to the fuel pump and carburetor by flare nuts.

CARBURETORS

1 bbl., 2 bbl. and Carter A.F.B. carburetors and specifications are identical to those used on corresponding Tempest engines. Quadrajets carburetors on Firebird 400 engines use the following model numbers.

- 7027272 400 cu.in. A.T.
- 7027273 400 cu.in. M.T.
- 7037272 400 cu.in. A.T. w-A.I.R.
- 7037273 400 cu.in. M.T. Ram-Air*
- 7037276 400 cu.in. A.T. Ram-Air*

* With or without A.I.R.

All additional information regarding servicing and adjustments will be found in section 6B of the 1967 Pontiac Service Manual.